

Fixing Details / Specifications

UNDERDECK INSULATION

METALLIC ROOF

Rockloyd Mattresses/Rolls placed over expanded metal mesh welded to purlins, covered with LDPE film on outer face and aluminium foil or vinyl cloth on inner side and finally metal roofing sheets are fixed normally using standard fasteners.

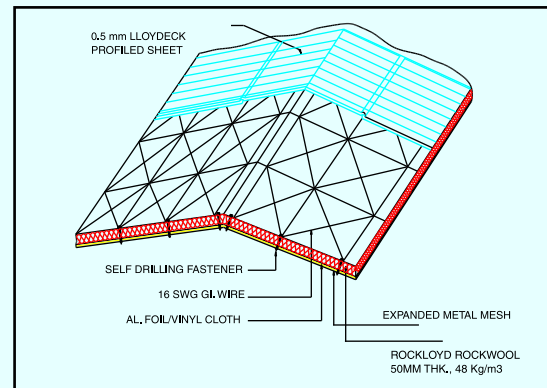

WALL INSULATION

Fixing GI Channels / wooden panels to walls and placing Rockloyd Slabs in between with LDPE film covering and finally providing facing of brick walls / plaster on wire netting / rigid boards secured to GI Channels.

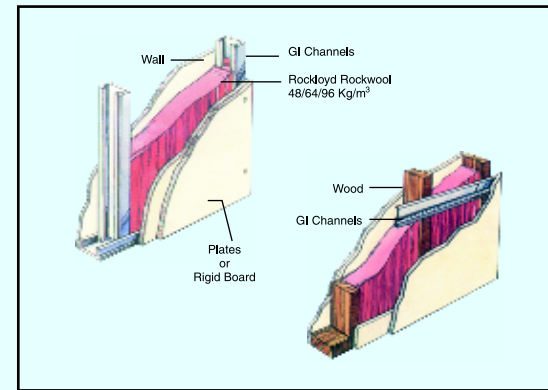

DUCT INSULATION

Fix self adhesive GI Pins on to the duct surface and provide Rockloyd Slabs over it, holding it in position with washer & nuts. Provide & apply the required finishing/cladding thereafter.

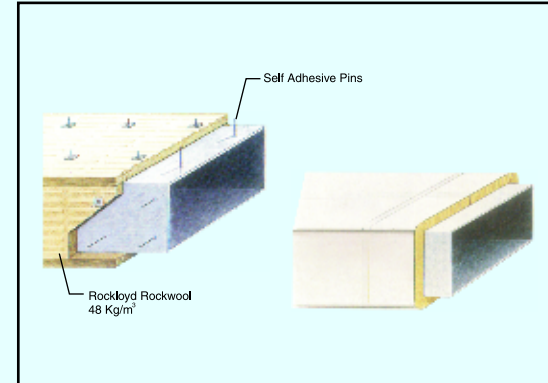

Incase of Rockloyd rolls, it is wrapped directly over the duct with the joints sealed with aluminium tape.

RCC ROOF

Fixing galvanised cleats to RCC and placing Rockloyd Mattresses/rolls in between and finally securing with wires/wiremesh. Internal finish of boards/sheets are optional.

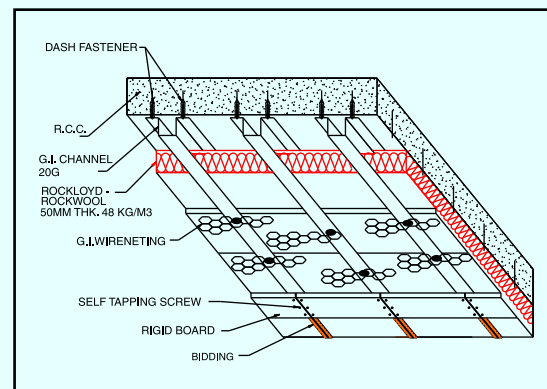

Rockloyd Building Insulation

FIRESAFE FIRE BARRIER INSULATION



Lloyd Insulations (India) Limited

(An ISO 9001, ISO 14001 & OHSAS 18001 Certified Organisation)

Post Box No. 4321, Punj* Premises, Kalkaji Industrial Area, Kalkaji, NEW DELHI - 110019
Phones : 011-30882900 - 30882906 Fax : 011-30882894, 26478601 E-mail : lloyd@del2.vsnl.net.in / LII_DELHI@eth.net

Post Box No. 19109, 386, Veer Savarkar Marg, Prabhadevi, MUMBAI - 400 025
Phones : 022 - 30480000, 30480110 Fax : 022 - 24376858, 24373557 E-mail : lloydinsul@vsnl.com

6, Middleton Street, KOLKATA - 700 071
Phones : 033 - 22871606, 22875479 Fax : 033 - 22872629, 22465687 E-mail : lloyd@cal2.vsnl.net.in / lloydkol@airtelmail.in

5, Haddows Lane, Off Haddows Road, Nungambakkam, CHENNAI - 600 006
Phones : 044 - 28273753, 28303753 Fax : 044 - 28279728 E-mail : lloyds@dataone.in / liichennai@eth.net

MANUFACTURING UNITS : Bhilai, Gwalior, Aurangabad & Jamshedpur



Wdya, June 2010



Think Energy Conservation
Think Environment Protection
Think Lloyd Insulations

Visit us at : www.lloydindia.com or www.lloydinsulation.com

Bonded Rockwool Slabs & Rolls

Rockloyd Rigid, Semi-Rigid Slabs & Rolls

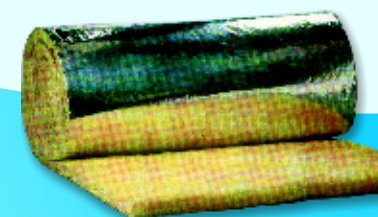

Rockloyd

Bonded Rockwool Products



MANUFACTURE

Rockloyd is manufactured from selected rocks melted at 1600°C and spun into fine fibres of diameter 4-5 microns. These fibres are then resin impregnated, felted and cured to form rigid, semi rigid, flexible slabs & rolls of optimum density and resilience. The fibres are laid in a parallel, pre determined pattern so that they are disposed perpendicular to the flow of heat. The fibres entrap millions of air cells in between, which resists passage of heat flow and sound waves, making Rockloyd a superior Insulant. Rockloyd has high density having more fibers per unit volume, ensuring outstanding insulation properties. Rockloyd Rolls / slabs can be factory laminated (with Kraft paper/ reinforced Aluminium Foil etc.) wherever needed. Rockloyd Rolls / Slabs are asbestos free.

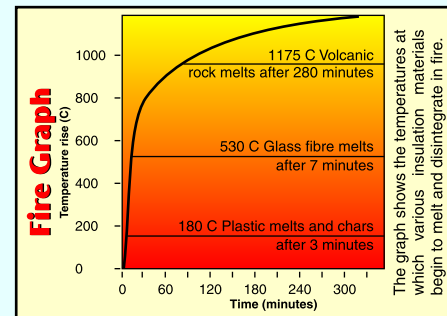

CHEMICAL COMPOSITION

Rockloyd has a basic composition in which the refractory oxide components have been deliberately increased to enhance its stability at high temperature. Rockwool fibres are chemically inert. The chemistry of Rockloyd has been engineered for the highest stability for limitless life under normal operating conditions.

FIRE PERFORMANCE

Rockwool has exceptional fire performance characteristics. Rockloyd products are rated non-combustible in accordance with BS : 476: Part 4, IS:3144, and IMO A163.

MAXIMUM TEMPERATURES

The limiting temperature of Rockwool fibres is 1000°C. Continuous service temperature limited to 800 deg.C. in consideration of limiting shrinkage.

BIOLOGICAL

Rockwool fibres do not promote the growth of fungi, moulds or bacteria and sustain vermin attack. Rockwool is completely rot proof and is absorbed by body fluids.

RESISTANCE TO MOISTURE

Rockwool fibers have been treated to repel water due to the presence of water repellent additives. Moisture absorption from the atmosphere is less than 0.02% by volume at 95% relative humidity, and the product resists capillary action. The fibre construction and laying pattern allows natural drying of Rockloyd in the event of local ingress of water.

ENVIRONMENT

Rockloyd is designed to be environmental friendly and is free from Asbestos.

COMPATIBILITY

Rockloyd is compatible with all materials with which it is likely to come into contact in normal building applications.

HANDLING AND STORAGE

Handling : Rockwool, being light in weight and properly constructed, is very easy to handle.

Storage : Rockwool products are usually supplied in flexible packs, which provide short-term protection. For long-term purposes, Rockwool should be stored safely in a building avoiding any overloading causing compression. If it has to be stored outside, it should be stacked clear of the ground and covered with an outer cover impermeable to moisture. If Rockwool does become wet during installation, it should be allowed to dry out naturally before the other finishes such as cladding are applied.

DISPOSAL

Rockwool is bio degradable and can be used for land fill.
**Material safety data sheets available

SPECIFICATION CONFORMANCE

IS :8183, 661 BS : 3958 Part-5
ASTM-C : 553, 612
IMO : for A-15, A-30 & A-60 Class Fire Barrier Insulation
Glasswool melts well before fire temperature is reached while Rockloyd stays on and protects even against raging fire.

AVAILABILITY

Rigid, Semi rigid and Flexible Slabs & Flexible Rolls.

DENSITY

Rockloyd is available in following standard densities.
Slabs - 48, 64, 96, 144 kg/m³
Rolls - 48 kg/m³

DIMENSIONS

Slabs - 1000mm x 500mm
1200mm x 750mm
Rolls - 12000mm x 500mm
(Other sizes are also available on request.)

THICKNESS

Slabs - 25,40,50,65,75 & 100mm
Rolls - 25 & 50mm
(Other thickness are also available on request.)

ACOUSTICS

Rockloyd features excellent noise reduction properties. Tests have shown that with suitably designed - constructions, excellent sound reduction can be achieved.

Noise Reduction Co-efficients of ROCKLOYD.

Thickness in mm	25*	50*	25**	50**
Density in kg/m ³				
48.0	0.65	1.0	0.78	1.04
64.0	0.73	1.03	0.84	1.11

*With rigid backing ** with 1" air gap

THERMAL CONDUCTIVITY

Rockloyd has very low conductivity values.

Mean Temp. (°C)	K values (W/mk)			
10	0.028			
24	0.033			
50	0.043			
100	0.052			
200	0.068			

THERMAL RESISTANCE (R=T/K)

Rockloyd provides excellent 'R' values (hr .ft² Deg F/BTU)

Mm	Density (kg/m ³)			
	48	64	96	144
25	3.9	4.1	4.2	4.4
50	7.9	8.1	8.4	8.9
75	11.8	12.2	12.5	13.3
100	15.8	16.2	16.7	16.7

DURABILITY

Rockloyd has been proved in service for over 25 years now in the country. Once installed right and maintained well, Rockloyd is practically Ageless. Rockloyd provides Economical insulation solutions, leading to Energy conservation & Cost savings.

FACING

Aluminium Foil, Vinyl cloth & Kraft Paper. Other facings are also available on request.

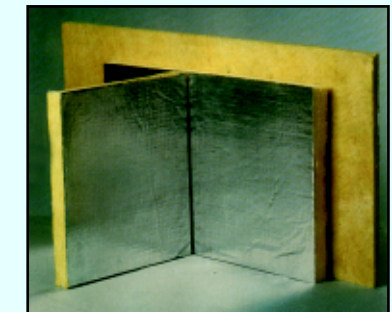

APPLICATION

For Thermal & Acoustical Insulation of Ceilings, Walls, Floors, partitions, Ducts, Enclosures & industrial appliances.

Rockloyd Rolls & Slabs are ideal for Underdeck Insulation of metal buildings for superlative insulation and fire protection.



TECHNICAL SERVICES

Lloyd Insulation Technical Services Department, staffed by insulation experts, is ready to give help and advice on any problems connected with all products in the Rockwool range.

TECHNO ECONOMIC INSULATION

